

# CORNER RESTORATION

CORNER N ¼ corner  
Sec. 9 TWP 14S RANGE 32E

ORIGINAL SURVEY BY: S. W. Lackland

CONTRACT NUMBER: 357

CONTRACT DATE: July 2, 1880

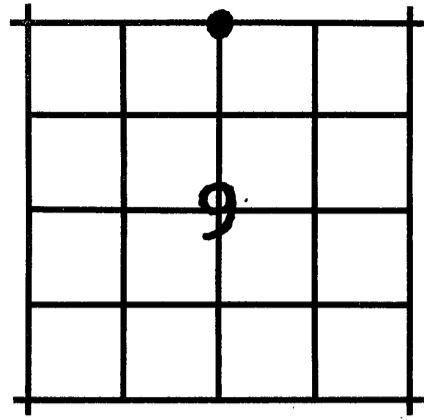

**ORIGINAL DESCRIPTION:**

S. 89° 37' W. on true line between Secs. 4 and 9.

40.00 set stone 24x18x12 in mound of stone for ¼ sec. cor. from which:

A pine 30" in diam. brs. S. 83° E., 40 lks. dist.

A pine 20" in diam. Brs. N. 85° W., 70 lks. dist.

**RESTORATION BY, STAMP AND DATE:**

R. D. Bagett  
 W. Gentis

REGISTERED  
 PROFESSIONAL  
 LAND SURVEYOR

*Robert D. Bagett*

OREGON  
 JULY 12, 1963  
 ROBERT D. BAGETT  
 598

June 30, 1976

Grant County Surveyor

**EVIDENCE FOUND:**

Found original stone 27"x12"x7" marked ¼S

I did not find original BTs. However, I did find part of BT blaze with scribing visible on a chunk of wood that had been torn from a stump during logging operation.

**DESCRIPTION OF MONUMENTS AND ACCESSORIES SET AND METHODS USED:**

Show how trees are scribed and basis of bearings, including compass var.

At the corner point: Set 1½"x30" iron pipe 26" in the ground in a mound of stone with brass cap marked as shown. Placed original stone west and alongside pipe. From which I scribe NEW BT's.

**MONUMENT MARKED**

A pine 8" in diam. brs. N. 61° E., 24.7 ft. mkd. ¼S4CSBT.  
 A pine 6" in diam. brs. S. 18° E., 26.5 ft. mkd. ¼S9CSBT.

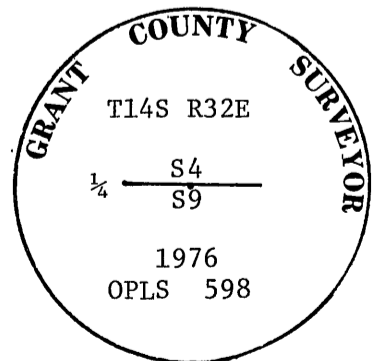

¼ corner is 3.5 feet West of old North-South fenceline.

Used compass with 20° East variation and steel tape measuring to face of blaze.

**RECEIVED AND  
 FILED**

DEC 20 1976  
*John Liveira*  
 JOHN LIVEIRA, County Clerk

By \_\_\_\_\_ Deputy